

This plat of 112 acres in Laurens County

on a branch of Enoree (alt. the Beaver dam) was laid out for John Coker bounded as the plat. Survey 12 April 1797 by S. Deane D.S.

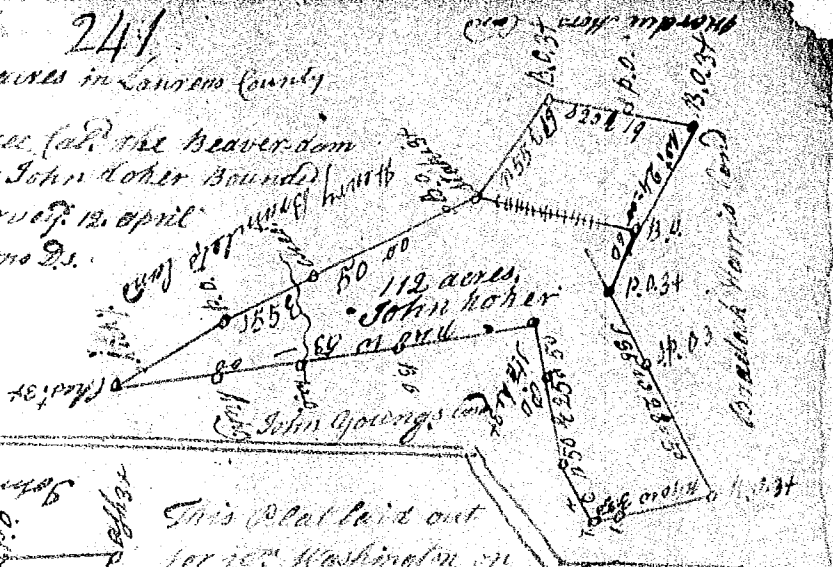

This plat laid out for Mr. Washington on the branches of Kedy river bounding as the plat. Survey 21 March 1797. John Coker recorded 10 May 1797

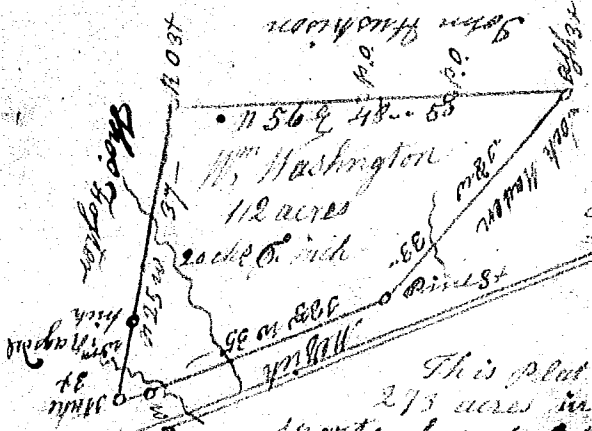

This plat of 273 acres in Spartanburg County was surveyed for Isaac Peeler the 20 April 1797.

Country Mease D.S. Recorded 10 May 1797

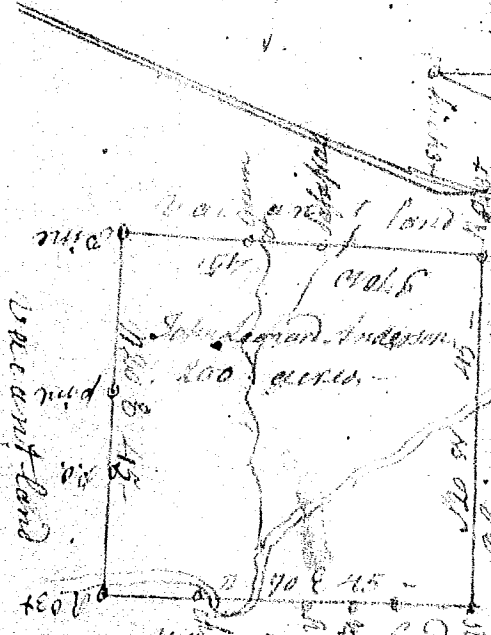
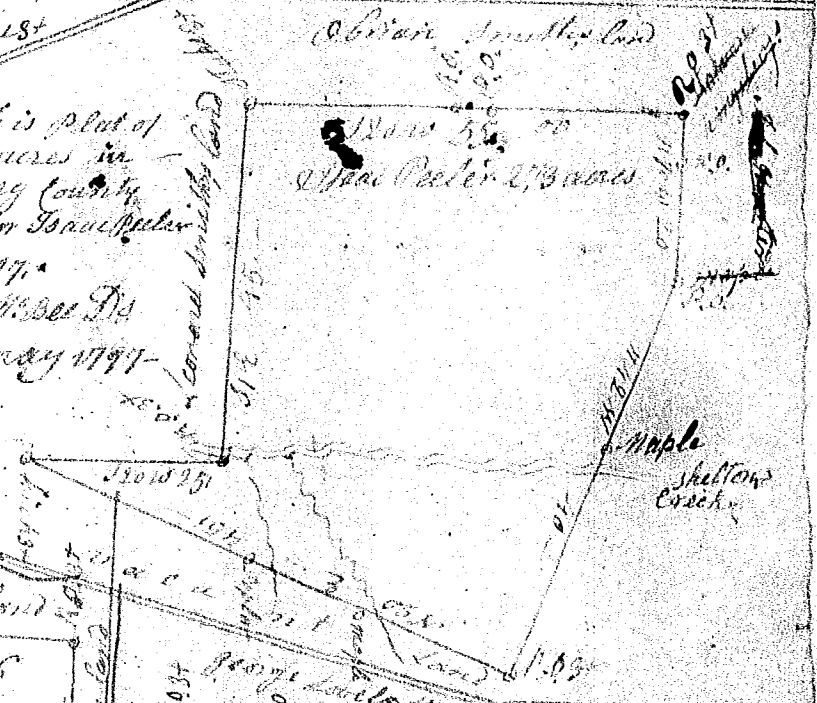

This plat of 200 acres in Spartanburg County Shelton Creek of the Kedy, bounded as the plat. Survey 20 April 1797 by Country Mease D.S. Recorded 10 May 1797



308 acres Laurens County, branches of Enoree Creek, bounded as the plat. Survey 14 Dec. 96. Wm. Humber D.S.